

# BOARD LEVEL POWER SEMICONDUCTOR HEAT SINKS

## 206 SERIES

VERTICAL MOUNT HEAT SINK

TO-220

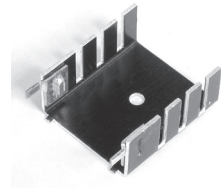

| Standard P/N | Height Above PC Board in. (mm) | Maximum Footprint in. (mm) | Thermal Performance at Typical Load |                   |
|--------------|--------------------------------|----------------------------|-------------------------------------|-------------------|
|              |                                |                            | Natural Convection                  | Forced Convection |
| 206-1PABEH   | 1.18 (30.0)                    | 1.00 (25.4) x .50 (12.7)   | 56°C rise @ 4W                      | 7.3°C/W @ 200LFM  |

**Material:** Aluminum, Black Anodized

### MECHANICAL DIMENSIONS

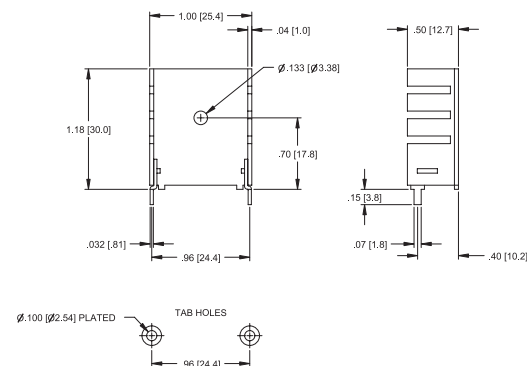

### NATURAL AND FORCED CONVECTION CHARACTERISTICS

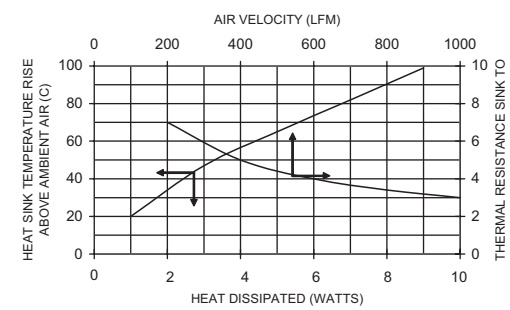

TO-220

## HORIZONTAL MOUNT HEAT SINK

## 241 SERIES

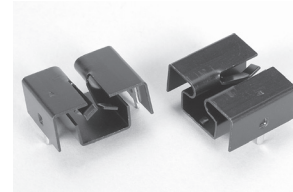

| Standard P/N | Height Above PC Board in. (mm) | Maximum Footprint in. (mm) | Thermal Performance at Typical Load |                   |
|--------------|--------------------------------|----------------------------|-------------------------------------|-------------------|
|              |                                |                            | Natural Convection                  | Forced Convection |
| 241-69ABE-03 | .39 (9.9)                      | .86 (21.8) x .69 (17.5)    | 77°C rise @ 4W                      | 12°C/W @ 200LFM   |

**Material:** Aluminum, Black Anodized

### MECHANICAL DIMENSIONS

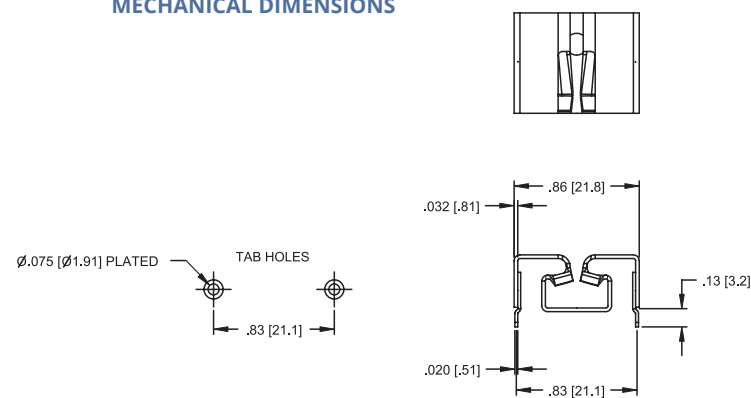

### NATURAL AND FORCED CONVECTION CHARACTERISTICS

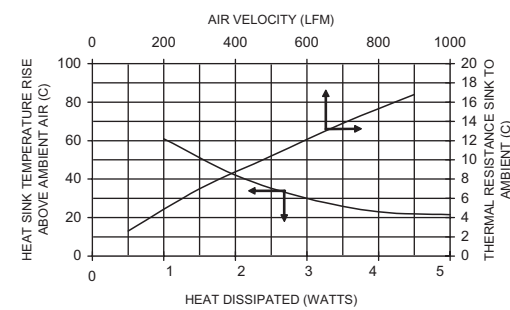

## COMPACT, WAVE-SOLDERABLE LOW-PROFILE SELF-LOCKING HEAT SINKS

## 230 & 234 SERIES

TO-220

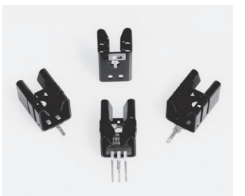

| Standard P/N | Height Above PC Board in. (mm) | Footprint Dimensions in. (mm) | Mounting Configuration | Solderable Tab Option | Mounting Style | Thermal Performance at Typical Load |                   |
|--------------|--------------------------------|-------------------------------|------------------------|-----------------------|----------------|-------------------------------------|-------------------|
|              |                                |                               |                        |                       |                | Natural Convection                  | Forced Convection |
| 230-75AB     | .750 (19.1)                    | .570 (14.5) x .500 (12.7)     | Vert./Horiz.           | No Tab                | Clip/Mtg Hole  | 57°C @ 2W                           | 7.5°C/W @ 400 LFM |
| 230-75ABE-01 | .750 (19.1)                    | .570 (14.5) x .500 (12.7)     | Vertical               | 01                    | Clip/Mtg Hole  | 57°C @ 2W                           | 7.5°C/W @ 400 LFM |
| 230-75ABE-05 | .500 (12.7)                    | .750 (19.1) x .570 (14.5)     | Horizontal             | 05                    | Clip/Mtg Hole  | 57°C @ 2W                           | 7.5°C/W @ 400 LFM |
| 230-75ABE-10 | .875 (22.2)                    | .570 (14.5) x .500 (12.7)     | Vertical               | 10                    | Clip/Mtg Hole  | 57°C @ 2W                           | 7.5°C/W @ 400 LFM |
| 234-75AB     | .790 (20.0)                    | .570 (14.5) x .500 (12.7)     | Vert./Horiz.           | No Tab                | Clip/Mtg Hole  | 57°C @ 2W                           | 7.5°C/W @ 400 LFM |
| 234-75ABE-01 | .790 (20.0)                    | .570 (14.5) x .500 (12.7)     | Vertical               | 01                    | Clip/Mtg Hole  | 57°C @ 2W                           | 7.5°C/W @ 400 LFM |
| 234-75ABE-05 | .500 (12.7)                    | .790 (20.0) x .570 (14.5)     | Horizontal             | 05                    | Clip/Mtg Hole  | 57°C @ 2W                           | 7.5°C/W @ 400 LFM |

**Material:** Aluminum, Black Anodized

### MECHANICAL DIMENSIONS

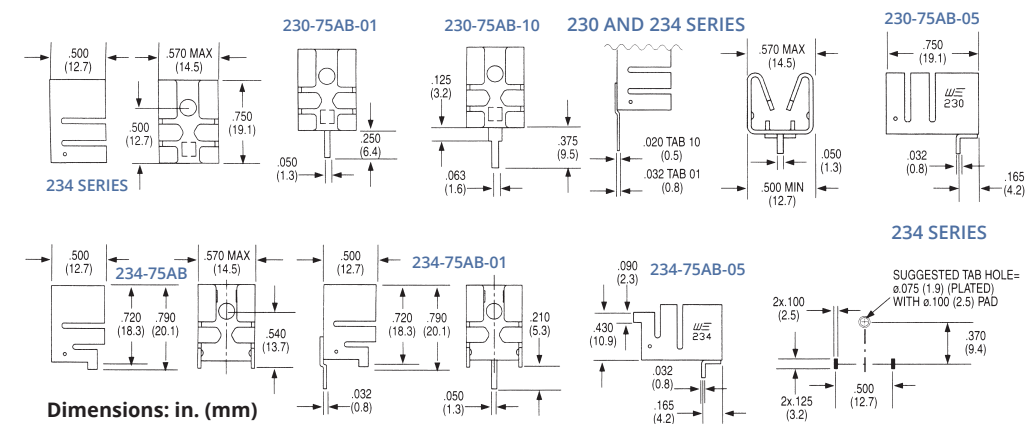

### 230 SERIES SUGGESTED TAB HOLE = Ø.075 (1.9) (PLATED) WITH Ø.100 (2.5) PAD

### NATURAL AND FORCED CONVECTION CHARACTERISTICS

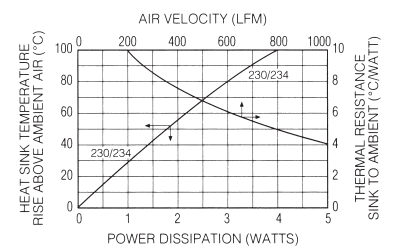

## 262 SERIES

HORIZONTAL AND VERTICAL MOUNT HEAT SINK

TO-220

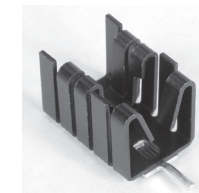

| Standard P/N | Height Above PC Board in. (mm) | Maximum Footprint in. (mm) | Thermal Performance at Typical Load |                   |
|--------------|--------------------------------|----------------------------|-------------------------------------|-------------------|
|              |                                |                            | Natural Convection                  | Forced Convection |
| 262-75ABE-05 | .53 (13.4)                     | .75 (19.1) x .50 (12.78)   | 80°C rise @ 2W                      | 10°C/W @ 200LFM   |
| 262-75ABE-01 | .75 (19.1)                     | .53 (13.4) x .50 (12.7)    | 80°C rise @ 2W                      | 10°C/W @ 200LFM   |

**Material:** Aluminum, Black Anodized

### MECHANICAL DIMENSIONS

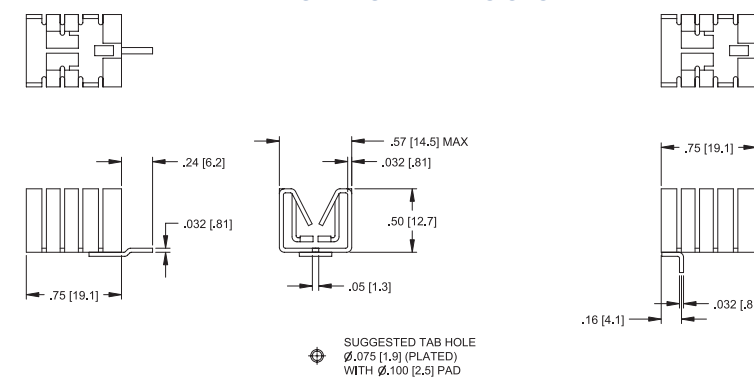

### NATURAL AND FORCED CONVECTION CHARACTERISTICS

